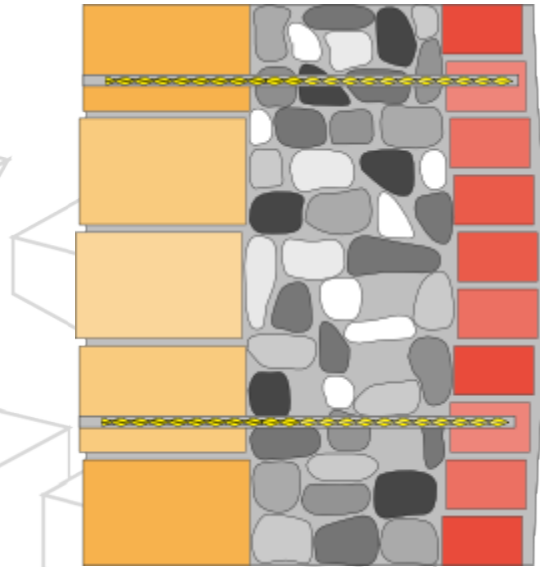
Solid Masonry WallRubble Fill Wall**METHOD STATEMENT**

1. Drill a clearance hole (13mm-16mm diameter depending upon material and the length of tie to be used) through outer leaf of wall and three quarters of the way into the inner leaf.
2. Blow out hole and thoroughly flush with water.
3. Mix Bond Flex cementitious grout and load into gun with required length of correct size extension nozzle already attached.
4. Pump cementitious grout to outlet of nozzle. Insert nozzle to the full depth of drilled hole and pump grout to fill hole. Keep light pressure on gun to ensure that all voids are filled with grout.
5. Wind correct length Cem Flex into the hole using the Cem Flex insertion tool.
6. Make good at surface of all holes and leave ready for any decoration.

Guidance Notes : Unless specified otherwise the following criteria are to be used.

- a. Cem Flex to be installed at a density of 2.5 per square metre (i.e. 900mm horizontal and 450mm vertical spacing and alternate rows staggered).
- b. Around openings density to be increased and Cem Flex installed at 300mm vertical spacing and 225mm back from the opening.